

# AIRCONCEPTS

AIR DISTRIBUTION PRODUCTS



UPD SERIES

# UPD

## Umbrella Plaque Diffuser

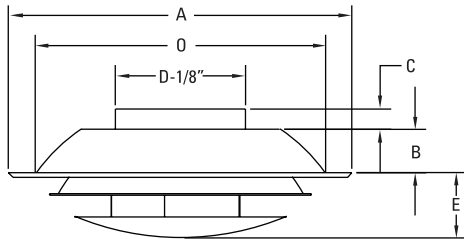

HORIZONTAL AIR PATTERN

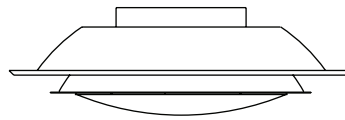

VERTICAL AIR PATTERN

### Swirl Diffuser Dimensions in Inches

MODEL	A	B	C	D	O	E	E
UPD-06	15-3/4	2-1/4	1-1/4	6	13-3/8	2-7/8	1-7/8
UPD-08	15-3/4	2-1/4	1-1/4	8	13-3/8	2-7/8	1-7/8
UPD-10	22-1/2	3-1/4	1-1/4	10	20-1/4	3-11/16	2-11/16
UPD-12	22-1/2	3-1/4	1-1/4	10	20-1/4	3-11/16	2-11/16

### High Velocity/ High Aspiration Air Outlet

Distinctive Architectural Design  
Adjustable Horizontal / Vertical  
Air Pattern

### Construction

Heavy gauge aluminum

### Finishes

Standard: #52 White powder coat  
Optional standard: #00 Mill  
#12 Anodized powder coat  
#42 Gloss black powder coat  
#43 Flat black powder coat  
#72 Silver metallic powder coat  
Custom colors available

<b>MODEL</b>	<b>Duct Velocity (FPM) Velocity Pressure ("WG)</b>	<b>400 0.010</b>	<b>600 0.023</b>	<b>800 0.040</b>	<b>1000 0.062</b>	<b>1200 0.089</b>	<b>1400 0.122</b>
<b>UPD-06</b>	CFM	78	118	157	196	235	274
	Total Pressure (Horizontal)	0.022	0.050	0.087	0.137	0.168	0.270
	NC (Horizontal)	<15	<15	<15	<15	20	26
	Radius of Diffusion (Horizontal)	1-2-5	2-4-7	3-5-8	4-6-9	5-7-11	4-8-12
	Total Pressure (Vertical)	0.038	0.085	0.133	0.240	0.250	0.340
	NC (Vertical)	<15	<15	<15	18	24	30
	Vertical Projection	2-4	5-10	7-14	9-18	13-26	15-30
<b>UPD-08</b>	CFM	140	209	279	349	419	489
	Total Pressure (Horizontal)	0.025	0.055	0.098	0.152	0.220	0.300
	NC (Horizontal)	<15	<15	<15	16	23	28
	Radius of Diffusion (Horizontal)	2-3-6	3-5-8	4-6-9	5-8-11	6-10-13	7-11-16
	Total Pressure (Vertical)	0.040	0.090	0.162	0.250	0.360	0.500
	NC (Vertical)	<15	<15	<15	23	29	34
	Vertical Projection	3-6	6-12	10-20	13-26	16-32	19-38
<b>UPD-10</b>	CFM	218	327	436	545	654	764
	Total Pressure (Horizontal)	0.027	0.058	0.105	0.160	0.230	0.320
	NC (Horizontal)	<15	<15	<15	19	26	32
	Radius of Diffusion (Horizontal)	2-4-7	3-5-9	5-7-13	6-9-14	7-11-16	8-12-19
	Total Pressure (Vertical)	0.043	0.096	0.172	0.270	0.390	0.530
	NC (Vertical)	<15	<15	16	24	30	36
	Vertical Projection	5-10	9-18	12-24	15-30	20-40	22-44
<b>UPD-12</b>	CFM	314	471	628	785	942	1100
	Total Pressure (Horizontal)	0.028	0.062	0.110	0.170	0.250	0.340
	NC (Horizontal)	<15	<15	<15	23	30	35
	Radius of Diffusion (Horizontal)	3-5-10	5-7-11	7-10-15	8-12-17	10-14-19	11-15-22
	Total Pressure (Vertical)	0.048	0.109	0.194	0.300	0.430	0.590
	NC (Vertical)	<15	<15	18	26	33	38
	Vertical Projection	6-12	10-20	14-28	19-38	23-46	25-50

performance data based on ASHRAE 70-91

**Noise Criteria:** Noise criteria [NC] curve which is not exceeded with a Room Attenuation of 10db and based on Sound Power Level Re: 10-12 watts.

**Terminal Velocity:** Maximum velocity (Vt) in feet per minute at the specified distance from the outlet face (THROW) 150 fpm, 100 fpm and 50 fpm respectively.

**Vertical Projection:** Projection distance [THROW] in feet - minimum value is 20-degree heating to 0 fpm terminal velocity and maximum value is 20-degree cooling to 100 fpm terminal velocity.

**Airflow CFM:** Standard air density and isothermal conditions.

**Radius of Diffusion:** Horizontal distance (THROW) in feet from the Diffuser at which the maximum velocity has been reduced to specified terminal velocity (Vt).

**Total Pressure:** Inches of water gauge required.