

## SATURN PLAQUE DIFFUSER

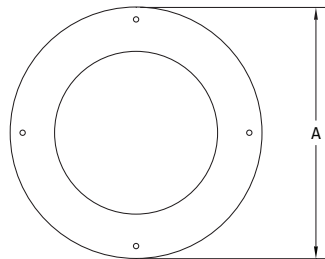
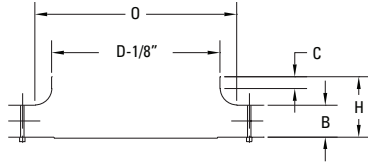

**HIGH VELOCITY /  
HIGH ASPIRATION AIR OUTLET**

- Distinctive round design
- Horizontal air pattern
- Ceiling or duct mount

| MODEL  | A     | B | C      | D  | H     | O      |
|--------|-------|---|--------|----|-------|--------|
| SPD-04 | 7-1/2 | 2 | 1-1/4  | 4  | 3-3/4 | 5-1/8  |
| SPD-06 | 10    | 2 | 1-3/16 | 6  | 4     | 7-1/2  |
| SPD-08 | 12    | 2 | 1-3/16 | 8  | 4     | 9-1/2  |
| SPD-10 | 15    | 2 | 1      | 10 | 4     | 11-7/8 |
| SPD-12 | 17    | 2 | 1      | 12 | 4     | 13-7/8 |
| SPD-14 | 20    | 2 | 1-1/4  | 14 | 4-1/2 | 16-3/8 |
| SPD-16 | 22    | 2 | 1-1/4  | 16 | 4-1/2 | 18-3/8 |
| SPD-20 | 28    | 3 | 1-1/2  | 20 | 6-1/4 | 23-3/8 |
| SPD-24 | 34    | 4 | 1-1/2  | 24 | 7-1/2 | 27-7/8 |

(Inches measured to the nearest 1/16")

### STANDARD FINISHES

- #10 clear anodized
- #12 anodized powder coat
- #42 gloss black powder coat
- #43 flat black powder coat
- #52 white powder coat
- #62 grey primer powder coat  
(on field painting)
- #72 silver metallic powder coat
- #99 custom color / color match  
(paint chip needed)

### STANDARD MATERIAL

- Heavy gauge aluminum

### OPTIONS

- Acoustical tile mounting kit

|                |   |                            |
|----------------|---|----------------------------|
| PROJECT :      | <h2>SPD SERIES</h2> <p>SATURN PLAQUE DIFFUSER</p> |                            |
| ARCHITECT :    |   |                            |
| ENGINEER :     |   |                            |
| CONTRACTOR :   |   |                            |
| SUBMITTED BY : | DATE :  | FORM # : 10060S            |
|                |   | DRAWN BY : MH JANUARY 2003 |