

## ALUMINUM PUNKAH LOUVER SPERICAL - PANEL SERIES

### HIGH VELOCITY TASK AIR OUTLET

- Low Noise Levels
- Low Pressure Requirements

### ADJUSTABILITY

- Easy Finger Tip Adjustment
- Directional Air Pattern Control:  
70° Global Rotation Minimum  
± 35° Deflection  
360° Rotation

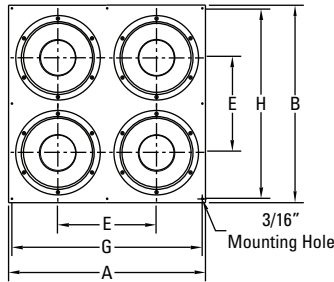
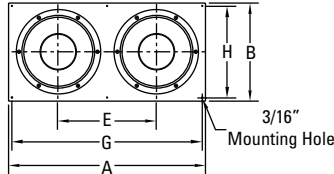
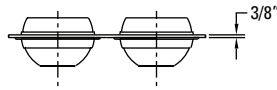

MODEL	APLS PER PANEL	A	B	DUCT SIZE	E	G	H
APLS-04-P2R	2	14	8	12 X 6	7	11	7
APLS-06-P2R	2	18	10	16 X 8	9-1/2	17	9
APLS-08-P2R	2	24	12	22 X 10	11-1/2	23	11
APLS-10-P2R	2	28	14	26 X 12	13-1/2	27	13
APLS-12-P2R	2	32	16	30 X 14	15-1/2	31	15
APLS-04-P4S	4	14	14	12 X 12	7	11	13
APLS-06-P4S	4	18	18	16 X 16	9-1/2	17	17
APLS-08-P4S	4	24	24	22 X 22	11-1/2	23	23
APLS-10-P4S	4	28	28	26 X 26	13-1/2	27	27
APLS-12-P4S	4	32	32	30 X 30	15-1/2	31	31

(Inches measured to the nearest 1/16")

#### STANDARD FINISHES

- #10 clear anodized
- #12 anodized powder coat
- #42 gloss black powder coat
- #43 flat black powder coat
- #52 white powder coat
- #62 grey primer powder coat (on field painting)
- #72 silver metallic powder coat
- #99 custom color / color match (paint chip needed)

#### MATERIAL

- Heavy Gauge Aluminum
- Foam Gasket

#### OPTIONS

- Custom Finish \_\_\_\_\_

#### NOTES

- Mounting Screws Included
- Custom Panel Sizes Available

PROJECT :	<h2>APLS PANEL SERIES</h2> <p>ALUMINUM PUNKAH LOUVER - SPHERICAL PANEL</p> <p>FORM # : 20018S</p> <p>DRAWN BY : MH JANUARY 2005</p>
ARCHITECT :	
ENGINEER :	
CONTRACTOR :	
SUBMITTED BY :	
DATE :	