

ALUMINUM PUNKAH LOUVER SERIES

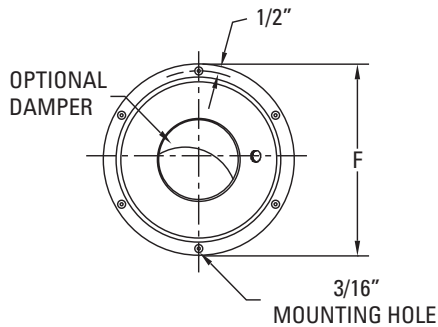

(Model APL-A shown w/ aperture damper)

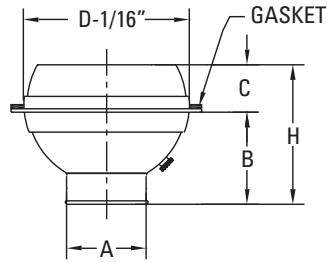

HIGH VELOCITY TASK / AIR OUTLET

- Low Noise Levels
- Low Pressure Requirements

ADJUSTABILITY

- Easy Finger Tip Adjustment
- Directional Air Pattern Control
- 70° Global Rotation Minimum
- ±35° Deflection
- 360° Rotation

MODEL	SIZE	A	B	C	D	F	H	MTG HOLES
APL-03 / *	3	1-5/8	1-3/4	15/16	3-1/8	5	2-11/16	3
APL-04 / APL-04A	4	2	2-9/16	3/4	4	6	3-5/16	3
APL-06 / APL-06A	6	3	3-1/16	1-7/16	6	8	4-1/2	4
APL-08 / APL-08A	8	4-3/8	4-1/4	1-3/4	8	10	6	4
APL-10 / APL-10A	10	5-3/4	5-1/2	2-7/8	10	12	8-3/8	6
APL-12 / APL-12A	12	7-3/8	6	3	12	14	9	6
APL-14 / APL-14A	14	8-5/8	7-1/8	4-1/8	14	16	11-1/4	6
APL-16 / APL-16A	16	9-3/4	8-1/4	4-3/4	16	18	13	6
APL-18 / APL-18A	18	10-1/2	9-1/2	4-1/4	18	20	13-3/4	8
APL-20 / APL-20A	20	12-3/8	10-7/8	4-7/8	20	22	15-3/4	8

(Inches measured to the nearest 1/16")

STANDARD MATERIAL

- Heavy Gauge Aluminum
- Stainless Steel Damper Hardware
- Foam Gasket

NOTES

- Mounting Screws Included
- "A" in Model Name Designates Aperture Damper
- * APL-03 / Not Available with Aperture Damper

OPTIONS

- Aperture Damper

STANDARD FINISHES

- #00 mill
- #10 clear anodized
- #12 anodized powder coat
- #42 gloss black powder coat
- #43 flat black powder coat
- #52 white powder coat
- #62 grey primer powder coat (on field painting)
- #72 silver metallic powder coat
- #99 custom color / color match (paint chip needed)

PROJECT :	<h2>APL SERIES</h2> <p>ALUMINUM PUNKAH LOUVER</p>
ARCHITECT :	
ENGINEER :	
CONTRACTOR :	
SUBMITTED BY :	
DATE :	FORM # : 20010S
	DRAWN BY : MH SEPTEMBER 2007