

AIR NOZZLE - LAY-IN PANEL SERIES

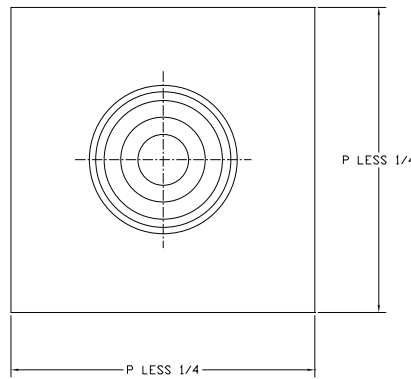
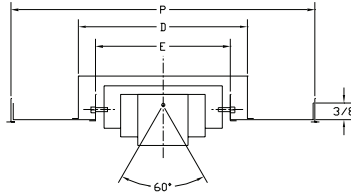

ADJUSTABILITY

- Adjustment of the nozzle element about a fixed plane through a 360° rotation.
- Note: Lay-in Tee-Bar Ceiling is Standard. Contact factory for other Ceiling Systems.

MODEL	E NOZZLE	RINGS PER NOZZLE	D DUCT	P PANEL
ANC-06-LI	6	3	8	24
ANC-08-LI	8	3	10	24
ANC-10-LI	10	3	12	24
ANC-12-LI	12	3	14	24
ANC-14-LI	14	4	16	24

(Inches measured to the nearest 1/16")

STANDARD MATERIAL

- Heavy Gauge Steel

OPTIONAL MATERIAL

- Heavy Gauge Aluminum
- Stainless Steel #304
- Stainless Steel #316

NOTES

- Flex Duct Mounting Collar Included
- Custom Sizes Available

STANDARD FINISHES

- #00 mill (aluminum)
- #10 clear anodized (aluminum)
- #12 anodized powder coat
- #42 gloss black powder coat
- #43 flat black powder coat
- #52 white powder coat
- #62 grey primer powder coat (on field painting)
- #72 silver metallic powder coat
- #99 custom color / color match (paint chip needed)

PROJECT :	<h2>ANC-LI SERIES</h2> <p>AIR NOZZLE - LAY-IN PANEL MOUNT</p>
ARCHITECT :	
ENGINEER :	
CONTRACTOR :	
SUBMITTED BY :	FORM # : 30014S
DATE :	DRAWN BY : MH JANUARY 2002